

NU200E series

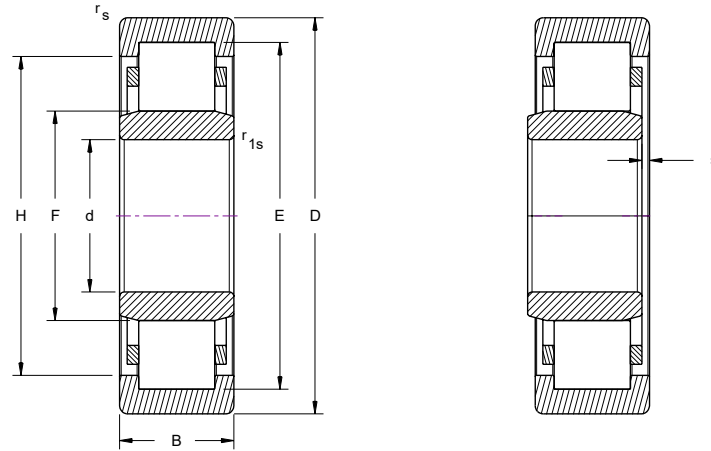

Bearing Number	Dimensions (mm)									Load Ratings (lbf)		Limiting Speed (RPM)	Weight (lbs)
	d	D	B	E	F	H	s*	r _s	r _{1s}	Dynamic	Static		
								min	min	Cr	Cor		
NU202E	15	35	11	30.3	19.3	28.0	1.6	0.6	0.3	2923	2248	22000	0.1
NU203E	17	40	12	35.1	22.1	32.5	1.2	0.6	0.3	3597	2923	18000	0.1
NU204E	20	47	14	41.5	26.5	38.8	0.8	1.0	0.6	5845	5171	16000	0.2
NU205E	25	52	15	46.5	31.5	43.8	1.2	1.0	0.6	6744	6295	15000	0.3
NU206E	30	62	16	55.5	37.5	52.5	1.5	1.0	0.6	8768	8768	12000	0.4
NU207E	35	72	17	64.0	44.0	61.0	0.7	1.1	0.6	11240	11240	10000	0.6
NU208E	40	80	18	71.5	49.5	68.3	1.0	1.1	1.1	12589	12364	9000	0.8
NU209E	45	85	19	76.5	54.5	73.3	1.0	1.1	1.1	14163	14837	8500	0.9
NU210E	50	90	20	81.5	59.5	78.3	1.3	1.1	1.1	14837	16186	8000	1.0
NU211E	55	100	21	90.0	66.0	86.6	0.8	1.5	1.1	19334	22256	7000	1.5
NU212E	60	110	22	100.0	72.0	96.1	1.6	1.5	1.5	21582	23830	6300	1.8
NU213E	65	120	23	108.5	78.5	104.3	1.4	1.5	1.5	24729	27427	6000	2.2
NU214E	70	125	24	113.5	83.5	109.4	1.2	1.5	1.5	27202	31698	5300	2.5
NU215E	75	130	25	118.5	88.5	114.4	1.2	1.5	1.5	29900	36082	5300	2.8
NU216E	80	140	26	127.3	95.3	122.9	1.3	2.0	2.0	31923	38442	4800	3.4
NU217E	85	150	28	136.5	100.5	131.5	0.8	2.0	2.0	37543	44737	4500	4.2
NU218E	90	160	30	145.0	107.0	139.7	1.5	2.0	2.0	41590	49908	4300	5.1
NU219E	95	170	32	154.5	112.5	148.6	0.7	2.1	2.1	50357	60698	3800	6.3
NU220E	100	180	34	163.0	119.0	156.9	1.5	2.1	2.1	56877	69916	3800	7.4
NU221E	105	190	36	171.5	125.5	165.1	1.3	2.1	2.1	59687	71489	3600	8.7
NU222E	110	200	38	180.5	132.5	173.8	1.5	2.1	2.1	66543	83404	3400	10.4
NU224E	120	215	40	195.5	143.5	187.8	1.4	2.1	2.1	77109	97792	3200	12.7
NU226E	130	230	40	209.5	153.5	201.2	1.2	3.0	3.0	82505	103525	3000	14.2
NU228E	140	250	42	225.0	169.0	216.7	2.0	3.0	3.0	90823	119823	2800	20.7
NU230E	150	270	45	242.0	182.0	233.2	4.0	3.0	3.0	97792	128366	2500	25.4
NU232E	160	290	48	259.0	195.0	249.6	4.1	3.0	3.0	y110606	146800	2300	30.9
NU234E	170	310	52	279.0	207.0	268.5	4.4	4.0	4.0	131738	173328	1600	38.6
NU236E	180	320	52	289.0	217.0	278.6	4.7	4.0	4.0	137133	184793	1600	41.7
NU238E	190	340	55	306.0	230.0	295.0	4.7	4.0	4.0	151971	206712	1200	49.6
NU240E	200	360	58	323.0	243.0	311.5	5.0	4.0	4.0	167483	229980	800	58.4

* Permissible axial displacement